

Round Pipe Separator Series 1630 Clamp-connection ISO 2852

Dimensions

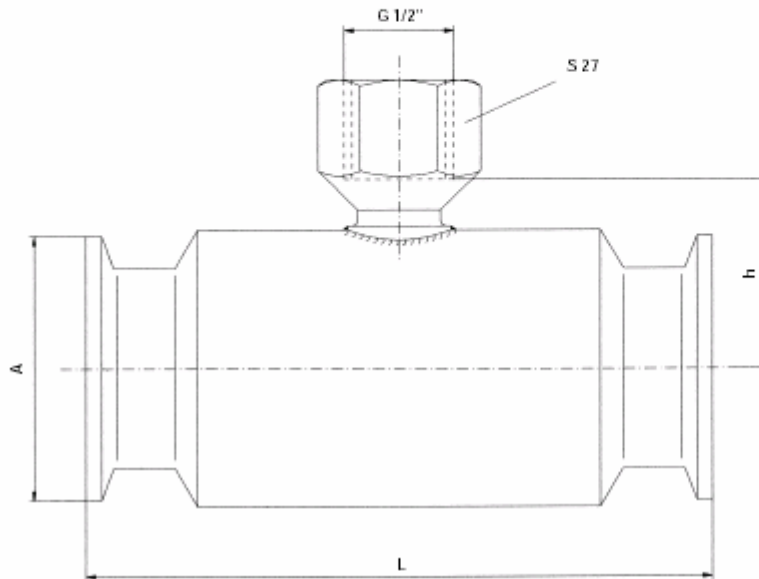

Dimension chart

| DN | A [mm] | L [mm] | h [mm] | Weight [kg] |
|--------|--------|--------|--------|-------------|
| 1 1/2" | 50.5 | 120 | 36 | 1.2 |
| 2" | 64 | 100 | 45 | 1.3 |
| 2 1/2" | 77.5 | 100 | 52 | 1.6 |
| 3" | 91 | 100 | 58 | 2.0 |

Pressure ranges (directive values)

| Mounting to pressure gauge or pressure transmitter | | NS 63 ¹⁾ | NS 80 | NS 100 | NS 160 | ED 518 |
|--|--------|---------------------|----------|----------|----------|----------|
| Pressure ranges [bar] with nominal size DN | 1 1/2" | 2.5...40 | 6...40 | 10...40 | - | 1...40 |
| | 2" | 2.5...40 | 4...40 | 6...40 | - | 1...40 |
| | 2 1/2" | 1.6...40 | 2.5...40 | 2.5...40 | 4...40 | 0.6...40 |
| | 3" | 1.6...40 | 1.6...40 | 1.6...40 | 2.5...40 | 0.6...40 |

¹⁾ Only possible with transition piece G 1/4 inside / G 1/2 outside.